

JUMBO EVENT - FOLDING DISPLAY BOARDS user instructions

1



Remove the Jumbo Event folding display board from its packaging and stand the display boards up.

2



Hold the edges of the display boards and pull open.

3



Position the display boards as above. Your Jumbo display boards are ready for use.

4



If you have ordered the optional header display board, place two locking clips in the top centre board aluminium edging.

5

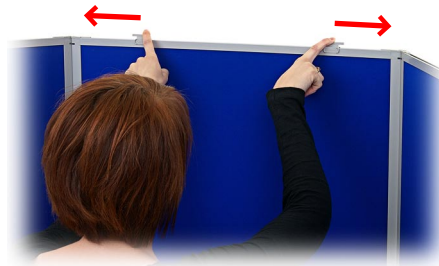

Ensure the arrow and word 'lock' on the locking clips face outwards as shown.

6



Place the header panel on the centre display board, as shown.

7

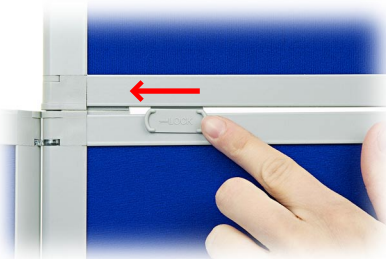

Slide the locking clips fully over to each edge. Ensure they lock into place.

8



Your Jumbo folding display board and header are now ready for use.