

## UNIVERSAL - PORTABLE DISPLAY BOARDS

### user instructions

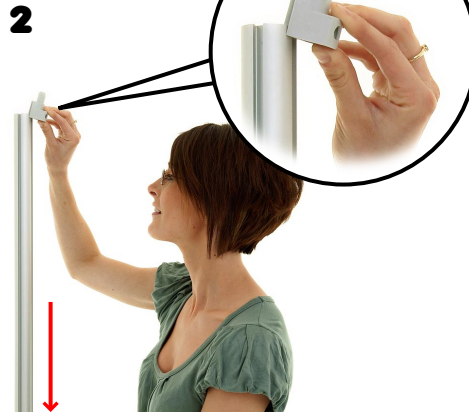

1 Lay the base on the floor and insert the pole into the base. Screw in tight.



2 Take a Universal corner fitting and drop down the channel section of the pole.



3 Secure the moulding into position with a screwdriver. Repeat this process on the second pole.



4 Lift one of the display board panels and position on top of both of the Universal corner fittings.



5 Slide another two corner fittings down the pole, one facing down, one facing upward. Secure with screwdriver. Twist pole for easy access to retaining screws.



6 Position the next display board on top, dropping into the corner fittings. Secure in position.



7 Insert the top corner moulding. Secure into position.



8 To add a header panel, insert the header pole and secure using the mouldings as above.



9 Continue with this process for as many panels as you require for your exhibition / display.